

# outdoor

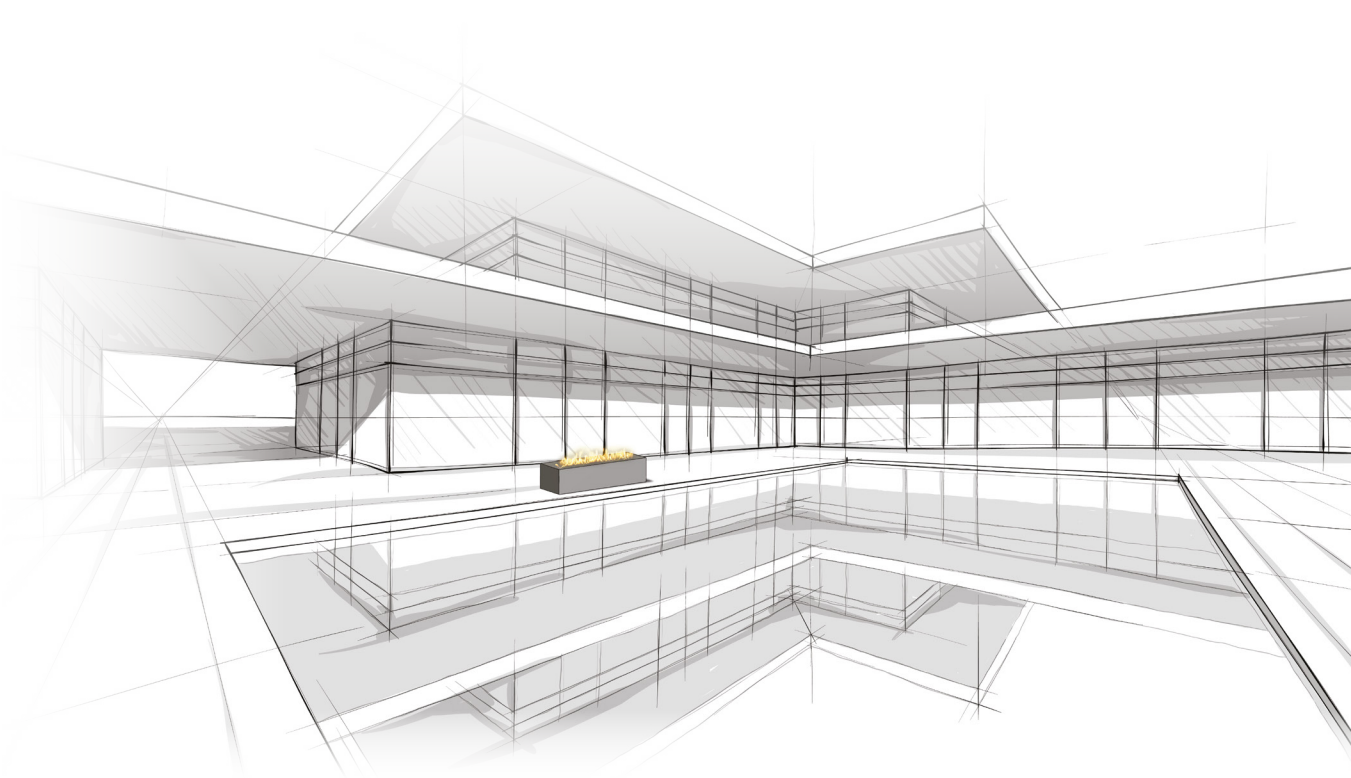

© PLANIKA | Ver. 03072017

[www.PLANIKAfires.com](http://www.PLANIKAfires.com)

# Galio Insert outdoor

## Galio Insert

Gas fireplace insert with a linear form

Creates a cozy and unique atmosphere in outdoor living spaces

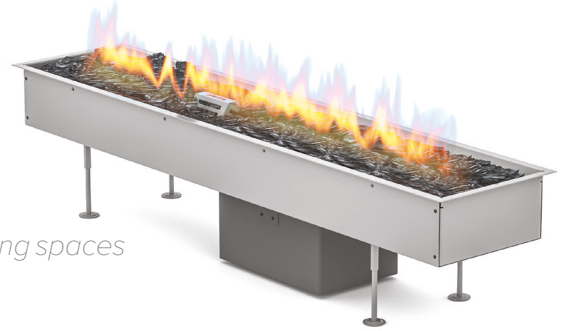

### FEATURES:

- For outdoor use
- Easy installation
- Flame height regulation
- Linear-shape burner
- LPG or natural gas powered
- Safety sensor
- No electrical connection required
- CE certified components

### TECHNICAL DATA:

Net weight: 21 kg / 46 lbs

LPG

Heat output: min. 6,3 kW (21 623 BTU); max. 11,8 kW (40 219 BTU)

Gas rate: min. 0,5 kg/h (1,1 lbs/h); max. 0,93 kg/h (2,05 lbs/h)

Gas pressure: 37 mbar/11" WC

NG

Heat output: min. 4,7 kW (16 108 BTU); max. 9,4 kW (32 215 BTU)

Gas rate: min. 0,5 m<sup>3</sup>/h (17,7 ft<sup>3</sup>/h); max. 1,0 m<sup>3</sup>/h (35,3 ft<sup>3</sup>/h)

Gas pressure: 20 mbar/7" WC

Finish:

stainless steel



### DIMENSIONS:

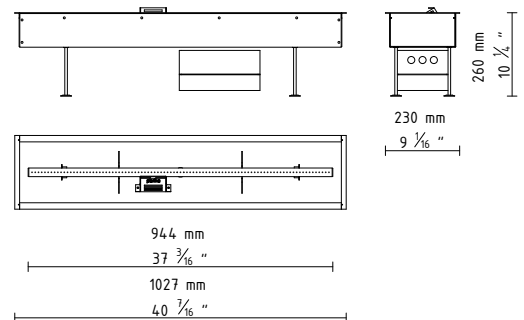

### INSTALLATION REQUIREMENTS:

